

HOUSE HISTORY

Documentary Sources

Presentation to The Ossett Family & Local History Network

Alan Howe
13th July 2012

Research based upon

The Cottages 7 & 9 Hags Hill Road Ossett



The History

- A pair of mid/late 18th Century cottages with attached mistal at **Lights Bridge** Ossett
- Owned/Built(?) by Ossett Woolstapler **Joshua Haigh** & occupied by **Pickard** Family (Clothiers/Weavers) 1740(?) to 1945
- Bought by **ISAAC PICKARD** 1918
- First floor once used for weaving – access by rear doors now blocked
- Described in 1813 as “ancient premises” & thought to be built on site of earlier building
- Cottages owned and occupied by the same families for more than 200 years
- Remember **Hags Hill, Pickard, Joshua Haigh & Lights Bridge** as we go through the sources

What is House History?

- In its simplest term it is what it says
- How old is the building, who built it, who owned it and when?
- Why was it built there? Can you identify an exact date of construction?
- Does it still exist? Was it demolished/replaced? Has it been adapted or extended?
- These are bricks and mortar questions
- **But is this enough?** The house was a home. Who lived there & when?
- How did they live their lives? What type of house was it and who lived in the neighbourhood?
- What was the land use before the house was built?
- Who owned the land then?
- Construct the **story** of the house to reflect those lives. Where did the adults work, which schools did the children attend, what were the living conditions like.....?
- The History of the House is the history of the people who lived there and the setting –the neighbourhood – it is also family and local history

Documentary Sources

- Conveyance/ Solicitors' files
- **2012-1832** Electoral Registers (and earlier Poll Books)
- **2012 -1974** Land Registry freehold & some leasehold transactions
- **1984 -1880** Telephone Directories (www.ancestry.co.uk)
- **1970 -1704** West Yorkshire Registry of Deeds freehold and some leasehold Deed Memorials
- **1961** Ossett Year Book & Dewsbury & District Directory
- **1940 -1943** National Farm Surveys of England and Wales
- **1925 – 1844** Rate Books & Assessments (Various years within this period)
- **1911 – 1841** Census records including Enumeration District descriptions. What they say about properties.
- **1910** Inland Revenue (“Domesday”)Valuation.
- **1905& 1913** Ossett Burgess Rolls
- **1843** Ossett Tithe Award
- **1813** Ossett Inclosure Order
- **1795** Poor Law Rate Collector’s Record
- **1781-1832** Land Tax Records & **1798** Land Tax Redemption record
- **1775** Ossett Valuation
- **1723** Wakefield Census (excluding Horbury). Ossett was not included
- **1709** Wakefield Manor Book
- **1672** Hearth Tax
- **1274 - 1925** Wakefield Court Rolls for Copyhold land transactions (Yorkshire Archaeological Society, Leeds)
- **Other Sources** Maps, Wills & Inventories, Newspapers, Land Auctions, Obituaries, Estate papers, Council Clearance Orders, Planning Applications/Consents, Books, Publications, Photographs, YVBSG, Trade Directories, Bartlett
- **Websites** Find My Past address search; Google Street View / Images. Cassini Map overlays; Tracks In Time (Leeds Tithe Awards; Leodis/Twixt Aire & Calder (Leeds/Wakefield old photographs) British Newspapers
- Get to know your documents – the order in which information is collected over the years is key eg Land Tax Records to 1781- 1803.

Where to begin- Preliminary work

- Start in the present with what you know
- **Try to find the name of an owner pre 1970 to enable access to The Registry of Deeds**
- Check your Conveyancing records & contact your solicitor
- Check Electoral Registers & Telephone Directories - more later
- Check 1910 Inland Revenue Valuation – more later
- Check 1911 Census Summary Sheets
- Check Wills if you think you have a name – more later
- Contact The Land Registry –more later
- Speak to the previous owners and people who live close by- especially the older ones! Check your Council's archived planning records. Many now online from 1974
- Check old maps of the area to see when the house was first mapped (website ref old maps)
- Try <http://www.findmypast.co.uk> which can search by address up to 1911.
- **See Example 1 for a Find My Past Address Search**

Conveyance/Solicitor's Records

- May help to discover an owner pre 1970
- Will show the previous owner and date of conveyance. May show plan & earlier owners
- Is there an Epitome or **Abstract of Title** ?
- Solicitors' records may reveal more history.
- If bought from an estate of a deceased person check Probate/Will records
- From 1974 Compulsory **first** registration with Land Registry for Wakefield area properties
- **See Example 2 for an Abstract/ Epitome of Title**

Electoral Registers

- Electoral registers are lists of names of people entitled to vote, arranged (after 1918) by address. Introduced 1832 & more or less annually thereafter.
- Various available at British Library (complete from 1947) & Local Studies Offices
- Need to identify Constituency (Ossett has changed several times) & Poll District
- Jeremy Gibson's [Electoral Registers 1832-1948](#) (3rd edition. Family History Partnership, 2008) will give archival location of registers
- Commercial websites <http://www.192.com/people/electoral-roll/> & <http://www.peopletraceonline.co.uk/> allow searches 2002-2012 for a fee.
- Since 1918 the principal division of parliamentary registers has been the Polling District. The arrangement within polling districts is normally by street in alphabetical order within which properties are in street order
- British Library (01937 546060) & <http://www.findmypast.co.uk> are scanning Registers 1832-1932. These should be online in 2012.
- Voting qualifications changes have increased the franchise ie; 1 in 3 men by 1867
2 in 3 men by 1884; Men over 21 & women over 30 by 1918; All adults over 21 by 1928; All adults over 18 by 1969

See Separate note re Electoral Rolls and Poll Books

Land Registry

From 1974 Compulsory **first** registration with Land Registry for Wakefield properties
Order a Title Register Copy &/or Title Plan (£4 each) Shows latest registration details.
Postcode/address to locate but can do online by mapping
Can apply to see if they hold any earlier registrations(Form HC1)
Land Registry also hold some Pre Registration Deeds - ask and/or submit FOI 2002 request
Land Registry may hold Abstract of Title etc -ask
Contacts www.landregistry.gov.uk
West Yorks land transactions contact Nottingham Land Registry phone 0115 935 1166
Be careful –there are commercial websites containing the name “land registry” which charge much more than £4 for Register copy/ Title plan

See Example 3 for a Title Register Copy & Plan

Telephone Directories 1880-1984

- The British Telecom Archives in the City of London hold almost the complete set of telephone directories for England and Wales since 1880 - these can now be searched and viewed online on a subscription basis at [ancestry.co.uk](https://www.ancestry.co.uk)
- This online collection contains over 1700 phone books published between 1880 and 1984 and provides near full county coverage for England and Wales
- Telephone books are very useful for pinpointing individuals in a particular place and time - while censuses are only conducted once every ten years
- Annually published phone books provide a year by year record of individuals' geographic locations - this makes it possible to locate many individuals in between census years and especially to find family members post 1911
- BUT you need a name of the occupier....not many households had telephones until post 1950not possible to search Directories by address.

West Yorkshire Registry of Deeds

- Memorials of Deeds voluntarily registered with Deeds Office **1704-1970**
- Deeds for freehold and some leasehold in old West Riding area
- Deeds do not include copyhold land (see Wakefield Court Rolls)
- Searchable by seller for 1704-1763
- Searchable by buyer and seller 1763 -1970
- Searchable by **location** 1704-1787 & 1884-1923
- Include description of site & maybe field names
- May provide clues as to the presence of a house/building
- May include more specific addresses & site plans from about 1880's onwards.
- Pre 1850's Deeds a problem is often identifying location. Field names & adjacent ownerships are often used to define the subject of the Deed. See Tithe Awards below for Field Names.
- Contact West Yorkshire Archives Service WYAS Newstead Road Wakefield 01924 305980
Appointments needed <http://www.archives.wyjs.org.uk>
- Copies of Deeds/Plans can be purchased
- See Separate Registry of Deeds Collections note for more details

1961 Ossett Year Book & Dewsbury and District Directory

- Fifty years ago these documents provided information about Ossett residents & businesses and the work of the Borough Council
- In the *Dewsbury Directory*, Streets are listed alphabetically for the whole of the Dewsbury District with Ossett streets marked with an “O”. Residents are listed within street by house number or name.
- Businesses are listed alphabetically within trades usually with address of the business
- The *Ossett Year Book* provides addresses for Members and senior Officers of the Council. Less useful for this purpose the Book also lists all the post WWII Borough Election results Mayors from 1890 and Local Board Chairmen 1871-1890
- Also it records a schedule of Ossett Borough Council land and property ownerships often with date of acquisition, cost, vendor and purpose. There is in addition a schedule of housing provided by the Council and a list of important dates in the Town’s history which also includes dates relating to the opening of some housing /development schemes.
- Both of these book are in private hands but check with Dewsbury & Wakefield Local Studies for copies
- **See Example 4 for an extract from the 1961 Dewsbury Directory**

National Farm Surveys 1941-1943

- WWII began Sept 1939. Britain had to increase home food production.
- In June 1940 a farm survey was begun to achieve this. By early 1941 some 85% of the agricultural area was surveyed - all but the smallest farms.
- There followed a more general National Farm Survey to provide data to inform post-war planning. Hence the National Farm Surveys 1941-1945
- Every holding (300,000) above 5 acres was surveyed, recording condition, tenure, occupation, acreage, livestock numbers and a map. 1-5 acre holdings also surveyed
- Farms were graded
- Available only to view at National Archives. Series MAF 32 (Individual farm records - Ossett Parish holdings found in MAF32/1151/513/xxxx). Where xxxx is individual farm holding reference
- To obtain this need to use OS maps in MAF73/49 (West Riding) Search for Ossett map to identify xxxx ie the number of the holding.
- One of the most controversial parts of the Survey, and the one for which the Survey is often remembered, lies under section D, 'Management', of the Primary Farm Survey. It was here that the recorder had to classify the farm as A, B, or C, and if B or C were due to 'personal failings' he was also obliged to supply additional details

Rate Books Valuations & Assessments

- These records usually list names of persons liable to pay rates to the local authority, with a description of property for which rates were paid.
- The lists show in alphabetical (eg 1844) or street order (eg 1881) of owners; tenants (some show sub-tenants), property description, acreage & rateable value.
- Some (1844) do not show much information regarding location. Others (1881) are very specific
- All show detailed information regarding the property (eg type – dwelling, mill, etc) indicating for example in 1881 the number of stories (sic), size in sq yds, other buildings etc associated with the dwelling, mills, warehouses.
- By 1921 the property information is much less detailed
- Ossett Rate/Valuation Books for 1844,1862,1880,1881,1901,1915,1921 are available at WYAS (For Ossett see Series WMT/OS/8/1/)

Census 1911-1841

- **1911** Street address, house number/name, number of rooms [eg *Haggs Hill Road 4 rooms**]
- **1911** Enumerator District Summary Books lists address/occupier /building type/uninhabited buildings
- **1901-1891** Street, often house number/name, no. rooms if under five. Uninhabited dwellings records occupied/unoccupied [1901 *Haggs Hill Road 4 rooms*; 1891 - *South Parade-4 rooms**]
- **1881** Street, Inhabited or Uninhabited, less often house number/name [*South Parade**]
- **1871 - 1861** Street/Area/District, Inhabited/Uninhabited [*Low Common**]
- **1851-1841** Street/Area/District No record of Inhabited/Uninhabited [*Low Common.**]
- **Enumerator District descriptions** are key to help reconstruct house location [*"Pickard's " is mentioned in 1861-1891 Enumeration District Descriptions*]
- Compare property location from Census to local map of the time to fix location. Check with 1821 Census.
- Compare with other **earlier** records & try to reconstruct location at an earlier time from the way records were collected eg 1821 Ossett census; 1781-1803 Land Tax (more later); 1795 Poor Law Assessment Book were recorded by collector following a route.
- Beware of changing addresses/house numbers as districts expand. The address may be different but the property remains the same [eg *Pickard 1891 South Parade-1901 Haggs Hill*]
- See Example 5 for 1911 Enumerator District Summary Book
- See Example 6 for 1891 Enumeration District Description

1910 Inland Revenue “Domesday” Valuation

- Finance (1909-1910) Act – a tax on capital appreciation of property due to Public Works. Survey undertaken 1910-1915
- Survey recorded in Field Books and shows owners, occupiers, interest (eg freehold), tenancy detail, size of property, market value & *sometimes* date of building, number of rooms, building condition, sketch plan
- *Final* survey Record can be accessed at **National Archives [Kew] London**. Copies can be ordered online.
- *Draft* Field Books [aka “Street Index”] show only property address, owner, occupier [sometimes a bit more] & can be viewed at WYAS Wakefield. Importantly it provides evidence of ownership in 1910-1915
- This is a key document in property search – it allows pre/post 1910 searches in WYAS Deeds Registry
- You may also wish to acquire the Final Survey Record from Kew. Each property has a 1910 assessment number and you need this to order the Final Survey Record.
- The easiest way to find it - look through the 3 Ossett Draft Field Books or Street Indices at WYAS (Series C243/135 or 136 or 137). Find your address & the Assessment number between 1 and 4590 (for Ossett)
- Alternatively you can obtain an OS map from Kew (or view one at WYAS – Series C243/) which has 1910 Assessment numbers annotated (in red) on each property.
- You can then order the Final Survey Record by post or online at www.nationalarchives.gov.uk To do this search IR series 58 for Ossett and your Assessment number will be in a range of 100 numbers each with a batch number between 27167 and 27212. [EG 27168 covers assessments 101-199]
- E.g. Pickard’s 1910 assessment number was 185. To order it online or by post quote IR58/27168/185
- See Example 7 & 8 for 1910 Valuation Final Survey Record & Map showing Pickard’s occupancy

Ossett Burgess Rolls 1905 & 1913

- Lists, in three wards (Central, East & West), those entitled to vote in Municipal County & Parliamentary Elections.
- Effectively these are ratepayers and, as rates were then collected door-to-door, their arrangement was in street order.
- Records alphabetically by name, abode (street but no house number), nature of qualification/description of qualifying property (usually dwelling house)
- Not evidence of property ownership – voters included tenants
- Available from a number of sources to purchase on CD rom [WYAS/Local Studies?]
- Many Borough Council Electoral records were lost in a flood in Ossett Town Hall

Ossett Tithe Award 1843

- Tithes were a 10% tax on the produce of the land originally paid by the parish for the upkeep of the church and its clergy
- Assessment and collection disputes, often fuelled by the hostility of Nonconformists to a church tax, were resolved by the Tithe Commutation Act of 1836.
- This allowed tithes to be changed into a fixed money payment, and involved the making of an award which identified the landowners and the property which they owned.
- The Ossett *Tithe Map* shows all “fields” in the Parish. Each has a reference number. Buildings, including dwellings, are also shown
- Use to cross refer to Tithe Apportionments in *Tithe Schedules* showing the owners, occupiers, location, acreage, use (eg meadow, arable) rent charge & Field Names.
- Field Names are invariably used in 18th/19th century Deeds to identify the location of the land/property which the subject of the Deed. Fields often contain buildings/dwellings
- Field names can change over time. Take care in interpretation
- The 1843 Tithe Award is useful in its own right AND it is the **only** document which identifies Ossett Parish field names/locations
- It provides a location and owner’s name in 1843 & is a key reference point for property searches on other documents eg in the Registry of Deeds.
- The Tithe Award Map is available at WYAS (series Z20/24) but not the Tithe Schedule**. The Map can be ordered online from National Archives as can individual pages (IR18/12746/ref of property from Tithe Map). Or the whole of the Tithe Schedule can be ordered from National Archives
- ** Except check WYAS ref WDP9/383 “Altered Award & Map”
- **See Example 9 & 10 for Tithe Award Schedule and Map showing Isaac Pickard as occupier.**

Ossett Enclosure Act & Order 1807-1813

- During the 18th and 19th centuries, enclosures were by means of local Acts of Parliament, called the [Inclosure Acts](#) to consolidated strips in open fields into more compact units, and enclosed much of the remaining pasture commons or *wastes*.
- Enclosures usually provided commoners with some other land in compensation for the loss of common rights, although often of poor quality and limited extent. Enclosure consisted of exchange in land, and an extinguishing of common rights. This allowed farmers consolidated and fenced off plots of land, in contrast to multiple small strips spread out and separated.
- Between 1750 and 1850 there were approximately 4,000 Enclosure Acts of Parliament.
- The 1813 Ossett Inclosure Order gave effect to the 1807 Act. The Order records wells, quarries, highways in addition to allotments to individuals and their responsibilities regarding water courses, hedges etc
- The Order and accompanying maps recorded the location and acreage of allotments and the name of allottees and it also records encroachments (properties built on common land without consent) & the maps do show buildings/dwellings and often show the freehold/copyhold owners.
- The Inclosure Map does not cover the whole of Ossett and is not to scale but it does record land ownership and properties almost 200 years ago. The Order and Maps can be seen at WYAS (Series A108)
- **See Exhibit 11 & 12 Order and Map references to Joshua Haigh's ownership**

Poor Law Collectors Book 1795

- The Poor law rate raised money for poor relief from the inhabitants of the parish, according to their ability to pay. Originally a form of local income tax, over time it evolved into the rating system — a property tax based on the value of real estate. In general, the poor-rate was paid by the tenant of a property rather than its owner.
- Failure to pay the poor-rate would result in a summons to appear before a Justices of the Peace who could impose a fine or the seizure of property, or even prison.
- The Poor Rate had to be collected and a number of collectors' note books have survived. Several are available, eg 1819-1820 (ref WMT/OS/8/1/46) in WYAS. The 1795 Collector's Book referred to here is in private hands
- The 1795 book records only names & amount paid. It does not record properties. However in conjunction with other documents (Census Enumeration & Land Tax records) the route taken by the Collector can be identified.
- It shows the same people recorded in the same order as they appear in the Land Tax records (which records owners/occupiers) of the time. These people lived in houses and the collector was knocking on their door.
- His collection began at the Alverthorpe boundary (then at Haggs Hill) & continued across Haggs Lane (now Teall Court) towards Teal Town Road (now Teall Street).The record shows Mark Pickard (Isaac Pickard's grandfather) living in one of the houses.
- **See Example 13 Mark Pickard (Isaac Pickard's grandfather) was living on Haggs Hill in 1795**

Land Tax 1781-1832

- Land Tax was introduced in 1692 and lasted until 1963. It was administered at local level and based on a tax quota for each parish which did not vary over the years.
- Land tax assessments annually list property owners and their tenants. The records for Ossett (Lower Agbrigg) between 1781 and 1832 are still available at WYAS (Series QE/13/1/23)
- They record owners and occupiers (but not sub-tenants) with amounts paid. Between 1781 and 1803 the Land Tax Collector recorded his collections on a route basis. In 1803/4 this changed to recording names on an alphabetical basis. Addresses are not recorded.
- Between 1781-1802 it is possible to re-construct this route by reference to other documents & since the amount collected from individuals remains constant. Additionally there is little turnover of owners and tenants in this period. Those there in 1781 are almost all there in 1802.
- New owners with new tenants appearing in the record suggests new dwellings being built.
- From 1803-1832 Land Tax records are alphabetical by name. Good for Family historians but less so for other purposes. It is possible though to compare annual Land Tax records to the 1841 (and 1821) Census.
- In 1798 owners could “redeem” their Land Tax liability by paying a lump sum equivalent to 15 years tax liability. This 1798 record can be purchased from Kew (series IR23/108/39 folios 121to128) or viewed on www.ancestry.co.uk
- 1798 Redemption certificates between the owner and tax collectors also exist and can be accessed & ordered online from National Archives. Obtain the Certificate reference (eg 66981) from the 1798 Redemption record and order (series IR24/80/ 66981) These are purported to often show much more information about the condition etc of individual properties.
- **See Example 14 & 15 for 1798 Assessment and Redemption Certificate**

1775 Ossett Valuation

- An Assessment made for the relief of the poor in the Township of Ossett
- Schedules of land ownerships in Ossett cum Gawthorpe in 1775 in alphabetical order of owner and specifies ownership by type (eg cottage,land,croft) acreage in acres, roods and perches & value per acre
- Location is usually specified by reference to Field Names making comparison possible with the 1843 Tithe Award and Memorials of Deeds
- Occasionally also gives names of previous owners
- The Book is part of The John Goodchild Collection (Drury Lane Wakefield WF1 2TD – telephone 01924 298929.
- See example 16 of an entry from the Valuation Book [*Joshua Haigh jnr “House & Lights Bridge Pighill”*]

1709 Manor Book & 1723 Wakefield Census

- A Survey to illustrate the need for additional Church accommodation – ***A Census of the Parish of Wakefield 1723***
- Records all towns in the Parish of Wakefield except Horbury. Ossett is not included.
- Records Names (both Surname & Given Name), number in family and number of communicants. There is no address information but the records are not in alphabetical order so may have been collected on a street by street basis. May be possible to construct Enumerator's route.
- The Census is part of The John Goodchild Collection (01924 298929). WYAS & Local Studies?
- ***1709 Wakefield Manor Book*** (Edited by John Charlesworth for YAS 1939) is a record of the Manor of Wakefield in 1709 recording, *inter alia*, the officers, freeholders, royalties and rent payers & a description/location of the land/property for which they have liability
- For example “ *George Pickard for a house & Garth on Ossett Lights*”
- **See Example 17 for a copy of entry from The Wakefield Manor Book 1709**

The Hearth Tax Returns of 1672 for Wakefield

- The hearth tax was introduced in England and Wales in 1662 to provide a regular source of income for the newly restored monarch, King Charles II. Sometimes referred to as chimney money, the hearth tax was essentially a property tax on dwellings graded according to the number of their fireplaces.
- The hearth tax was levied at 1 shilling per hearth between 1662 and 1689 on each householder according to the number of hearths in his or her dwelling. The administrators were required to compile lists of householders with the number of their hearths.
- Normally each entry cites a number of hearths and the name of an individual who may be the occupier or the owner. Where the entry includes more than one hearth, the number sometimes represents hearths in several buildings or a sub-divided one.
- By the 1662 Act certain hearths were exempted ie due to 'poverty or smallness of estate', and those in dwellings whose rentable value was 20 shillings a year or less. The **1664** Act limited exemption still further by **restricting it to dwellings with no more than two hearths** and no hearth which had previously been chargeable could be made exempt unless it became ruinous
- The record is of limited use in *specific* house history terms but does provide a 1672 view of the Township
- Hearth Tax records are available at Kew (Series E 179). An excellent website at www.hearthtax.org.uk with Hearth Tax Returns from across England and an array of statistical information. The Wakefield Return is in the John Goodchild Collection and may be available at WYAS/Local Studies Centre (?)
- See example 18 for a 1666 London Hearth Tax Return

Wakefield Court Rolls 1274-1925

- The Wakefield Court Rolls are an almost complete series of manorial rolls documenting the business of the Manor of Wakefield from 1274 to the dissolution of the Manor in 1925. The Manor was one of the largest in England and covered not just Wakefield, but a huge area of the West Riding from Holmfirth to Halifax, Heptonstall, Dewsbury and Normanton
- They record the business of the court baron (held three times a year at Wakefield) which dealt with enforcing manorial dues and transfers of land, and the court leet or tourn (held twice yearly at Wakefield, Halifax, Brighouse or Rastrick and Kirkburton) which dealt with law and order and common agriculture.
- Many of the Rolls are still accessible for researchers (by appointment) at the Yorkshire Archaeological Society [YAS] Clarendon House Clarendon Road Leeds LS2 9NZ (0113 245 7910). Many though are too fragile especially those for second half of the 18th century. The YAS series is MD225. Those earlier than 1723 are usually written in Latin.
- The Rolls record the decisions of the court baron regarding Copyhold land transactions – of which there are many in Wakefield/ Ossett. If it is not possible to trace land or property in the WYAS Registry Deeds it is probable that the land was copyhold (until about 1925).
- Transfers of copyhold land required the consent of the Lord of the Manor and those consents are recorded on the rolls – a copy of which would be maintained by the Manor and a copy would be given to the copyholder as evidence of the transfer. The transferee of the Copyhold would be “admitted as a tenant of the Lord”
- The Law of Property Act 1922 extinguished copyhold land but the first sale of land following the enfranchisement required the payment of a fee termed “manorial incident”
- [See Example 19 for a copy of Wakefield Manor Court Roll entry](#)

Other Sources

- **Maps Ossett** earliest OS is 1850; Alan Godfrey maps include several about 1900 & usually include a Trade Directory of corresponding date. [www.alangodfreymaps.co.uk] Invaluable to plot properties against Census Returns and other Sources. WYAS has an OS series. In addition to the OS maps the 1843 Tithe Award, 1813 Enclosure, 1795 Wakefield Manor Estate (YAS series MD), 1711 Lord Cardigan's New Park Estate map (Northants Archives) & Richard Glover's Medieval & Post Medieval Landscape of Ossett (available in local bookshops) also provide very useful reference maps for house historians.
 - **Wills & Inventories If Probate has been obtained.** Pre 1858 Wills available from Borthwick Institute York [http://www.york.ac.uk/library/borthwick/] and from Leeds Probate Office post 1858.[Form PA1S to return to Postal Searches and Copies Department Leeds District Probate Registry, York House, York Place, Leeds, LS1 2BA] Wills proved (ie probate granted) at Wakefield can be viewed at WYAS. A date of death & preferably a date for probate will be required.
Online; Pre 1858 Wills can be searched more simply by name and ordered from Borthwick on <http://www.origins.net> The National Probate Calender 1858-1966 can be searched on www.ancestry.co.uk where information and address of deceased is usually given. Date of Probate is also given to enable Wills to be ordered by post. Both Will and especially Inventories often provide specific details.
 - **Church records** can also be a useful source of information. The Church is often a substantial landowner in towns/villages & also a significant donee. Especially useful in relation to land and development close to Church site. WYAS hold many Church records
 - **Newspapers /Books** *BMD's Notices* often provide specific addresses at the date of BM&D; *Obituaries* will usually say something of the life of the deceased maybe including reference to their home(s). Advertisements for properties usually say something about tenure, age and condition. Date of newspaper helps date the property. Many 19th Century British newspapers now available online free/by subscription. Several local books too about Ossett/ Horbury/ Wakefield History
 - **Estate papers & Land Auctions** include reference to properties, condition, tenure etc and Auctions usually include plans. Dates of papers and auction helps to date the property
 - **Council Clearance/Improvement Orders** can tell when properties may have been demolished or improved. Plans often available. Ossett Borough records at WYAS (series WMT/OS)
 - **Books, Photographs, Publications** may include reference to the area being studied and identify key dates. Many books are available which may assist in dating your property. The Yorkshire Vernacular Buildings Study Group [YVBSG] have a comprehensive book list [www.yvbsg.org.uk]
 - **Trade Directories** exist back to 1822 for Ossett. Many also give private residents' names & addresses. Local Studies Departments have Directories for most local areas
 - **Ken Bartlett** Late local historian & author of "Wakefield & Horbury" Essential reading/reference containing transcribed local Wills (1404-1800), Tithe records, history of local buildings/locations etc. Mainly Horbury but also Alverthorpe & Thornes. Includes information which otherwise would take many days to research. Available on CD Rom.
- Examples of maps, newspaper items, estate papers, auctions & Trade Directories can be viewed following this presentation.**

Useful Websites

- www.alangodfrey.co.uk and <http://www.cassinimaps.co.uk> and <http://www.old-maps.co.uk> for maps
- <http://www.francisfrith.com> for old photographs, maps, books and memories
- <http://maps.google.co.uk/intl/en/help/maps/streetview> Google maps/street view/aerial. Also <http://www.bing.com/maps> and <http://www.britainfromabove.org.uk/asearch?search=ossett>
- <http://www.leodis.net> A photographic archive of Leeds
- <http://www.tracksintime.wyjs.org.uk> The Leeds Tithe Map project
- <http://www.twixtaireandcalder.org.uk> A photographic archive of Wakefield District
- <http://www.britishnewspaperarchive.co.uk> British Library site Newspapers 1800-1900. Subscription or Pay to view
- <http://infotrac.galegroup.com/itweb/44wmdl> British Library site as above with fewer covers but free with your WMDC Library card bar code . Also enter website via <http://www.wakefield.gov.uk/CultureAndLeisure/Libraries/LibrariesOnline/OnlineResources>
- www.ossett.net Ossett History Website courtesy of Steve Wilson
- <http://www.phpbb88.com/ossett> Ossett History forum and website courtesy of Neville Ashby
- <http://www.hearthtax.org.uk> Devoted to all things Hearth Tax
- <http://www.archives.wyjs.org.uk> West Yorkshire Archives Service <http://www.archaeology.wyjs.org.uk> WYJS Archaeological Services. Both operated by the West Yorkshire Metropolitan District Councils
- <http://www.nationalarchives.gov.uk> National Archives website
- <http://www.yas.org.uk> Yorkshire Archaeological Society . Repository for many things historic and keeper of the Manor of Wakefield Court Rolls.
- <http://www.direct.gov.uk/en/homeandcommunity/yourlocalcouncilandcounciltax/yourcommunity> Government website advice on genealogy research with links to other relevant sites
- <http://www.hiddenhousehistory.co.uk> Professional House Historians but site includes
- <http://www.english-heritage.org.uk> English Heritage website including Listed Buildings
- <http://www.yvbsg.org.uk> The Yorkshire Vernacular Buildings Study Group has recorded 1800 buildings in Yorkshire.

- This is not intended to be a comprehensive listing but hopefully includes many that will assist the house historian

House History – **Examples** of Documentary Sources

Example 1a - Address Search by findmypast.co.uk

See Slide 5

Dale Street Bottom	Ossett cum Gawthorpe	Dewsbury	Yorkshire (West riding)
Dale Street Mitchells Long Row	Ossett cum Gawthorpe	Dewsbury	Yorkshire (West riding)
Dale Street Mitchells Row	Ossett cum Gawthorpe	Dewsbury	Yorkshire (West riding)
Dale Street Pooles Row	Ossett cum Gawthorpe	Dewsbury	Yorkshire (West riding)
Dearden Street	Ossett cum Gawthorpe	Dewsbury	Yorkshire (West riding)
Dewsbury Road	Ossett cum Gawthorpe	Dewsbury	Yorkshire (West riding)
Dewsbury Road Wood Street	Ossett cum Gawthorpe	Dewsbury	Yorkshire (West riding)
Eldon Terrace Flush Dyke	Ossett cum Gawthorpe	Dewsbury	Yorkshire (West riding)
Flush Dyke	Ossett cum Gawthorpe	Dewsbury	Yorkshire (West riding)
Flush Dyke Wyngarth	Ossett cum Gawthorpe	Dewsbury	Yorkshire (West riding)
Gedham	Ossett cum Gawthorpe	Dewsbury	Yorkshire (West riding)
Glenholme Terrace	Ossett cum Gawthorpe	Dewsbury	Yorkshire (West riding)
Great Field Road	Ossett cum Gawthorpe	Dewsbury	Yorkshire (West riding)
Greatfield Road	Ossett cum Gawthorpe	Dewsbury	Yorkshire (West riding)
Haggs Hill	Ossett cum Gawthorpe	Dewsbury	Yorkshire (West riding)
Haggs Hill Road	Ossett cum Gawthorpe	Dewsbury	Yorkshire (West riding)
Headlands Road	Ossett cum Gawthorpe	Dewsbury	Yorkshire (West riding)
Headlands Road Westfield Street	Ossett cum Gawthorpe	Dewsbury	Yorkshire (West riding)
Headlands Westfield Street	Ossett cum Gawthorpe	Dewsbury	Yorkshire (West riding)
Headlands Westfield Street Runtlings Terrace	Ossett cum Gawthorpe	Dewsbury	Yorkshire (West riding)
Headlands Westfield Street Westfield Terrace	Ossett cum Gawthorpe	Dewsbury	Yorkshire (West riding)
Headlands Westfield Street Westfields	Ossett cum Gawthorpe	Dewsbury	Yorkshire (West riding)

Example 1b Address Search by findmypast.co.uk See slide 5

Address search 1901 census



Search criteria used:

County: **Any**
 Street name:
 Residential Place: **Ossett Cum Gawthorpe**

Results:

Your search has returned total **12** results.

[← redefine search](#)
[← back to address search results](#)
[⇒ new 1901 address search](#)
[⇒ 1901 person search](#)

Schedule	House ↑	Street	Civil parish	Registration district	County	Transcript	
134		Haggs Hill Road	Ossett cum Gawthorpe	Dewsbury	Yorkshire (West riding)	VIEW	☆
135		Haggs Hill Road	Ossett cum Gawthorpe	Dewsbury	Yorkshire (West riding)	VIEW	
136		Haggs Hill Road	Ossett cum Gawthorpe	Dewsbury	Yorkshire (West riding)	VIEW	
137		Haggs Hill Road	Ossett cum Gawthorpe	Dewsbury	Yorkshire (West riding)	VIEW	
138		Haggs Hill Road	Ossett cum Gawthorpe	Dewsbury	Yorkshire (West riding)	VIEW	
115		Haggs Hill Road	Ossett cum Gawthorpe	Dewsbury	Yorkshire (West riding)	VIEW	
116		Haggs Hill Road	Ossett cum Gawthorpe	Dewsbury	Yorkshire (West riding)	VIEW	
117		Haggs Hill Road	Ossett cum Gawthorpe	Dewsbury	Yorkshire (West riding)	VIEW	

Example 2 Abstract or Epitome of Title

See Slide 6

Epitome of Title

Relating to free hold property known as
land off Runtlings Lane, Ossett, West
Yorkshire

Oyez Stationery, Limited. Epitome of Title Draft Forms

DATE	NATURE OF DOCUMENT OR EVENT ¹	PARTIES ²	WHETHER ABSTRACT OR PHOTOGRAPHIC COPY ³	DOCUMENT NUMBER ⁴	WHETHER ORIGINAL DOCUMENT TO BE HANDS OVER ON COMPLETION
1902 May 10	INDENTURE	Eleanor Steele (1) Joshua Hirst Wheatley Joseph Wheatley and Rev. John Thornton Steele and John Shepley Stancliffe (2) The Mayor Aldermen and Burgesses of the Borough of Ossett (3)	Photostat copy	1	No
	ABSTRACT OF TITLE	of Godfre Illingworth	do	2	No
1963 Sept. 25th	CONVEYANCE	Charles Stanley Curtis Donald Curtis and William Kenneth Curtis (1) George Michael Lodge Hirst & Ralph Andrew Briggs Hirst (2)	do	3	No
do	MORTGAGE (with RECEIPT endorsed)	George Michael Lodge Hirst and Ralph Andrew Briggs Hirst to Midland Bank plc	do	4	No
1973 Oct. 31	CONVEYANCE	George Michael Lodge Hirst & Ralph Andrew Briggs Hirst(1) Midland Bank Ltd. (2) North British (First) Housing Association Ltd. (3)	do	5	No
1978	SEARCHES		do	6	No
1978 May 3rd	MORTGAGE	Messrs. G. M.L. & R.A.B. Hirst to Midland Bank Ltd.	do	7	No

Example 2 – Abstract of Title

See Slide 6

WYK 45296

Documents delivered by Messrs. Scatcherd & Co. Solicitors.

GENERAL BUILDINGS, 5 BOND COURT, LEEDS LS1 2SE
to H.M. Land Registry, Chalfont Drive, Nottingham NG8 3RN.

the 31st day of October 1975

Date	Description of Document	Remarks
	TITLE DEEDS AND DOCUMENTS RELATING TO UPPER HOUSE, SCHOLLES, HOLMFIRTH, Nr. HUDDERSFIELD	
letter 30 10 1975		
1935	PROBATE OF WILL of Mr. John Sanderson (with copy)	Land Registry Official Copy This copy may not be the same size as the original.
20 Sept. 1935	STATUTORY DECLARATION - Mrs. Harriet Mosley (with copy)	
12 Nov. 1935	COMPENSATION AGREEMENT - Manor of Wakefield (with copy)	
24 Dec. 1935	ASSENT - Mr. John Sanderson decd.	
1957	ABSTRACT OF TITLE - Personal Reps. of Annie Hirst decd.	
2 Mar. 1957	CONVEYANCE - Personal Reps. of Annie Hirst decd. to Mr. & Mrs. H. Mallinson	
2 Mar. 1957	LEGAL CHARGE - Mr. & Mrs. H. Mallinson to Mr. P. Hirst	
1968	ABSTRACT OF SEARCHES - Abstract of title	
1968	SEARCHES - Local Landon and Wakefield	
21 Oct. 1968	STATUTORY DECLARATION - Mr. H. Mallinson (with copy)	
25 Oct. 1968	CONVEYANCE - Mr. & Mrs. H. Mallinson to Mr. P. Keer	
1970	EPITOME OF TITLE of Mr. P. Keer	
14 Oct. 1970	CONVEYANCE - Mr. P. Keer to Mr. E.W.D. Craven	
1970	PASSING OF PLANS - re extension	
1971	PASSING OF PLANS - re garage	
28 Sept 1971	LEGAL CHARGE - Mr. E.W.D. Craven to the Provincial Building Society with VACATING RECEIPT endorsed dated 23rd. Oct. 1972	

1
2
3
4
5
6
7
8
9
10
11
12
13
14
15
16

Received the above Documents.

Delivered by (Signature)

Example 3a - Land Registry Title Plan

see Slide 8

H.M. LAND REGISTRY		TITLE NUMBER		
		WYK 384898		
ORDNANCE SURVEY PLAN REFERENCE	COUNTY	SHEET	NATIONAL GRID	SECTION
	WEST YORKSHIRE		SE 2819	F
Scale: 1/1250	WAKEFIELD DISTRICT		© Crown copyright 1976.	

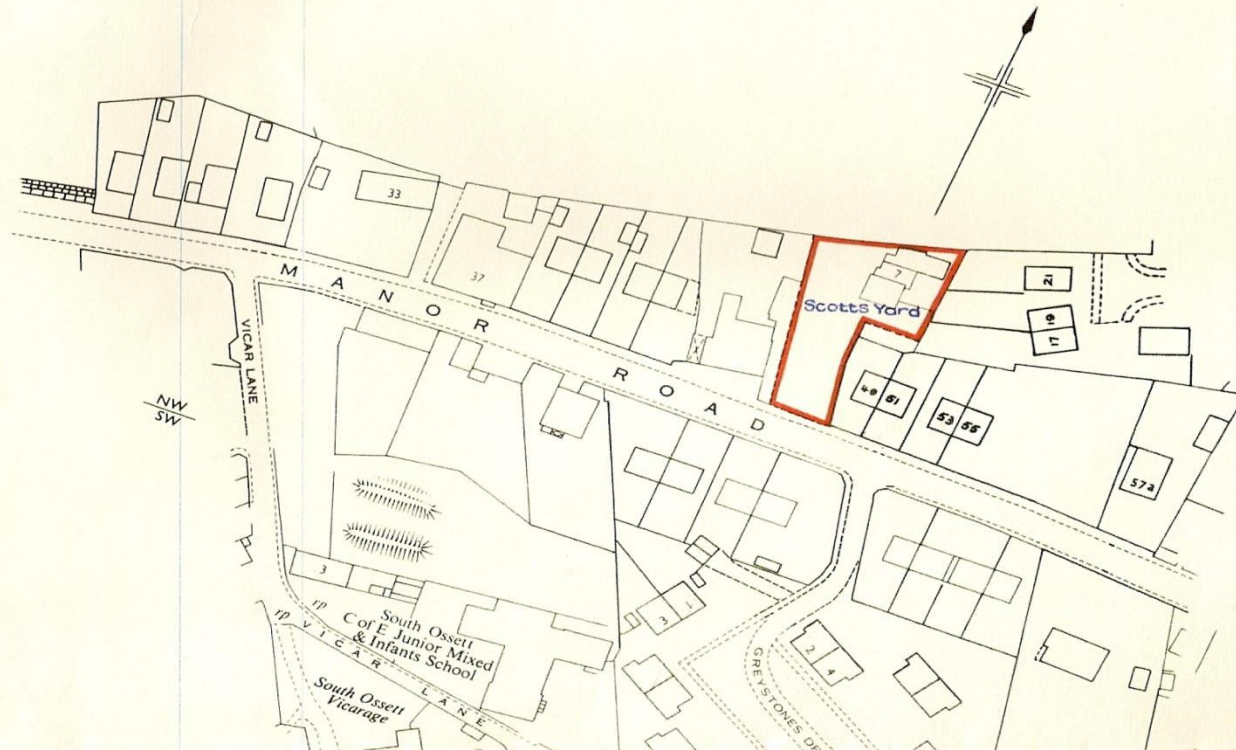

Example 3b - Land Registry Title Register

see Slide 8

Title Number : WYK307695

This title is dealt with by Land Registry Nottingham (West) Office.

The following extract contains information taken from the register of the above title number. A full copy of the register accompanies this document and you should read that in order to be sure that these brief details are complete.

Neither this extract nor the full copy is an 'Official Copy' of the register. An official copy of the register is admissible in evidence in a court to the same extent as the original. A person is entitled to be indemnified by the registrar if he suffers loss by reason of a mistake in an official copy.

This extract shows information current on 2008-10-06 at 19:56:50 and so does not take account of any application made after that time even if pending in the Land Registry when this extract was issued.

REGISTER EXTRACT

Title Number	: WYK307695
Address of Property	: land on the East side of New Gate, Upper House, Holmfirth
Price Stated	: Not Available
Registered Owner(s)	: [REDACTED] Eand and [REDACTED] of Shaley Farm, Scholes, Holmfirth, W Yorks.
Lender(s)	: None

Title number WYK307695

This is a copy of the register of the title number set out immediately below, showing the entries in the register on 2008-10-06 at 19:56:50. This copy does not take account of any application made after that time even if still pending in the Land Registry when this copy was issued.

This copy is not an 'Official Copy' of the register. An official copy of the register is admissible in evidence in a court to the same extent as the original. A person is entitled to be indemnified by the registrar if he suffers loss by reason of a mistake in an official copy. If you want to obtain an official copy, the Land Registry web site explains how to do this.

A: Property Register

This register describes the land and estate comprised in the title.

WEST YORKSHIRE : KIRKLEES

- 1 (22.02.1984) The Freehold land shown edged with red on the plan of the above Title filed at the Registry and being land on the East side of New Gate, Upper House, Holmfirth.
- 2 The land has the benefit of the rights granted by but is subject as mentioned in a Conveyance of the land in this title dated 10 February 1984 made between (1) David Edward Gibbins and Brian Robinson and (2) Adrian Stuart Waterhouse (Purchaser) in the following terms:-

"TOGETHER with the benefit of but SUBJECT to all rights of way water drainage watercourse light and other easements and quasi-easements and rights (if any) affecting the said property hereby conveyed"
- 3 The Conveyance dated 10 February 1984 referred to above contains the following provision:-

"IT IS HEREBY AGREED AND DECLARED that the boundaries of the property hereby conveyed marked with an inward "T" on the said plan shall belong to and be maintained and repaired by the Purchaser and his successors in title".

NOTE:-Copy Conveyance plan in Certificate. Copy plan filed.

B: Proprietorship Register

This register specifies the class of title and identifies the owner. It contains any entries that affect the right of disposal.

Title absolute

- 1 (12.04.2001) PROPRIETOR: [REDACTED] and [REDACTED], of Shaley Farm, Scholes, Holmfirth, W Yorks.
- 2 (12.04.2001) RESTRICTION: No disposition by a sole proprietor of the land (not being a trust corporation) under which capital money arises is to be registered except under an order of the registrar or of the Court.

End of register

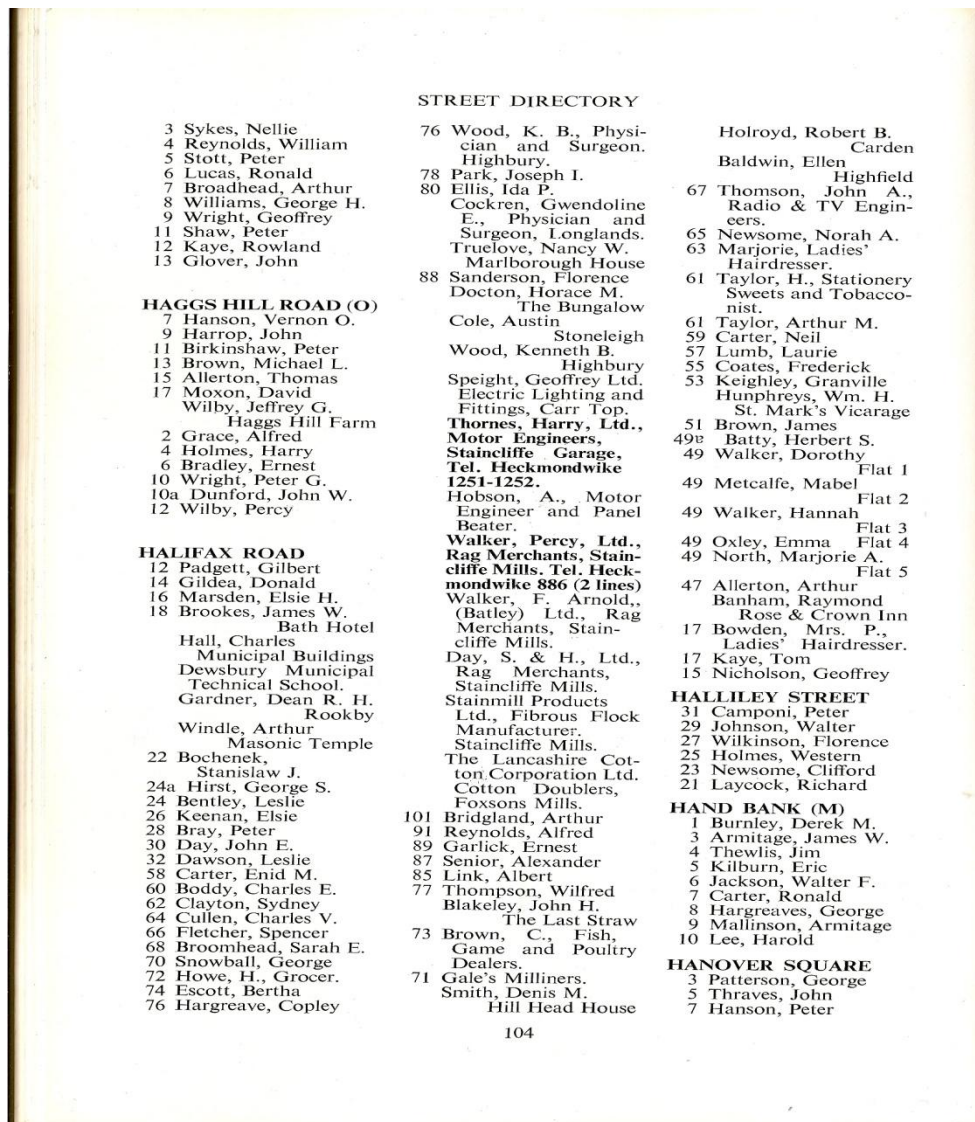

STREET DIRECTORY

3 Sykes, Nellie
 4 Reynolds, William
 5 Stott, Peter
 6 Lucas, Ronald
 7 Broadhead, Arthur
 8 Williams, George H.
 9 Wright, Geoffrey
 11 Shaw, Peter
 12 Kaye, Rowland
 13 Glover, John

HAGGS HILL ROAD (O)
 7 Hanson, Vernon O.
 9 Harrop, John
 11 Birkinshaw, Peter
 13 Brown, Michael L.
 15 Allerton, Thomas
 17 Moxon, David
 Wilby, Jeffrey G.
 Haggs Hill Farm
 2 Grace, Alfred
 4 Holmes, Harry
 6 Bradley, Ernest
 10 Wright, Peter G.
 10a Dunford, John W.
 12 Wilby, Percy

HALIFAX ROAD
 12 Padgett, Gilbert
 14 Gildea, Donald
 16 Marsden, Elsie H.
 18 Brookes, James W.
 Bath Hotel
 Hall, Charles
 Municipal Buildings
 Dewsbury Municipal
 Technical School.
 Gardner, Dean R. H.
 Rookby
 Windle, Arthur
 Masonic Temple

22 Bochenek,
 Stanislaw J.
 24a Hirst, George S.
 24 Bentley, Leslie
 26 Keenan, Elsie
 28 Bray, Peter
 30 Day, John E.
 32 Dawson, Leslie
 58 Carter, Enid M.
 60 Boddy, Charles E.
 62 Clayton, Sydney
 64 Cullen, Charles V.
 66 Fletcher, Spencer
 68 Broomhead, Sarah E.
 70 Snowball, George
 72 Howe, H., Grocer.
 74 Escott, Bertha
 76 Hargreave, Copley

76 Wood, K. B., Physi-
 cian and Surgeon.
 Highbury.
 78 Park, Joseph I.
 80 Ellis, Ida P.
 Cockren, Gwendoline
 E., Physician and
 Surgeon, Longlands.
 Truelove, Nancy W.
 Marlborough House
 88 Sanderson, Florence
 Docton, Horace M.
 The Bungalow
 Cole, Austin
 Stoneleigh
 Wood, Kenneth B.
 Highbury
 Speight, Geoffrey Ltd.
 Electric Lighting and
 Fittings, Carr Top.
**Thornes, Harry, Ltd.,
 Motor Engineers,
 Staincliffe Garage,
 Tel. Heckmondwike
 1251-1252.**
 Hobson, A., Motor
 Engineer and Panel
 Beater.
**Walker, Percy, Ltd.,
 Rag Merchants, Stain-
 cliffe Mills. Tel. Heck-
 mondwike 886 (2 lines)**
 Walker, F. Arnold,
 (Batley) Ltd., Rag
 Merchants, Stain-
 cliffe Mills.
 Day, S. & H., Ltd.,
 Rag Merchants,
 Staincliffe Mills.
 Stainmill Products
 Ltd., Fibrous Flock
 Manufacturer,
 Staincliffe Mills.
 The Lancashire Cot-
 ton Corporation Ltd.
 Cotton Doublers,
 Foxsons Mills.

101 Bridgland, Arthur
 91 Reynolds, Alfred
 89 Garlick, Ernest
 87 Senior, Alexander
 85 Link, Albert
 77 Thompson, Wilfred
 Blakeley, John H.
 The Last Straw
 73 Brown, C., Fish,
 Game and Poultry
 Dealers.
 71 Gale's Milliners.
 Smith, Denis M.
 Hill Head House

Holroyd, Robert B.
 Carden
 Baldwin, Ellen
 Highfield
 67 Thomson, John A.,
 Radio & TV Engin-
 eers.
 65 Newsome, Norah A.
 63 Marjorie, Ladies'
 Hairdresser.
 61 Taylor, H., Stationery
 Sweets and Tobacco-
 nist.
 61 Taylor, Arthur M.
 59 Carter, Neil
 57 Lumb, Laurie
 55 Coates, Frederick
 53 Keighley, Granville
 Humphreys, Wm. H.
 St. Mark's Vicarage
 51 Brown, James
 49^b Batty, Herbert S.
 49 Walker, Dorothy
 Flat 1
 49 Metcalfe, Mabel
 Flat 2
 49 Walker, Hannah
 Flat 3
 49 Oxley, Emma
 Flat 4
 49 North, Marjorie A.
 Flat 5
 47 Allerton, Arthur
 Banham, Raymond
 Rose & Crown Inn
 17 Bowden, Mrs. P.,
 Ladies' Hairdresser.
 17 Kaye, Tom
 15 Nicholson, Geoffrey

HALLILEY STREET
 31 Camponi, Peter
 29 Johnson, Walter
 27 Wilkinson, Florence
 25 Holmes, Western
 23 Newsome, Clifford
 21 Laycock, Richard

HAND BANK (M)
 1 Burnley, Derek M.
 3 Armitage, James W.
 4 Thewlis, Jim
 5 Kilburn, Eric
 6 Jackson, Walter F.
 7 Carter, Ronald
 8 Hargreaves, George
 9 Mallinson, Armitage
 10 Lee, Harold

HANOVER SQUARE
 3 Patterson, George
 5 Thraves, John
 7 Hanson, Peter

Example 5 Census Enumerator District Summary Book 1911 See Slide 14

Civil Parish.		Ecclesiastical Parish.		Borough or Urban District.						
<i>Assett (pt of)</i>		<i>South Assett Christ Church (pt of)</i>		<i>Assett M. B. (pt of)</i>						
Ward of Borough or Urban District.		Rural District.		Parliamentary Borough or Division.						
<i>East (pt of)</i>		<i>North Division of Yorkshire (pt of)</i>								
No. of Schedule.	Address.	Kind of Building. (For Blocks of Flats and Model Dwellings the Numbers of separate Flats or Tenements must be stated.)	Name of Occupier.	Dwellings or Tenements.			Population.			
				In-hab. htd.	Un-inhab. htd.	Build- ing not used as dwell- ings.	Males.	Fe- males.	Per- sons.	
1.	2.	3.	4.	5.	6.	7.	8.	9.	10.	11.
240	83 South Parade	Private House	Mr. J. Sykes	1				5	3	8
241	85 "	"	" J. Hey	1				1	1	2
242	87 South Leigh	"	" J. F. Goldthorpe	1				8	5	13
243	89 "	"	" W. H. Hey	1				6	4	10
244	91 "	"	" H. Bartley	1				6	1	7
245	93 "	"	" R. H. Dearlan	1				3	5	8
246	94 "	"	" J. Lister	1				2	2	4
247	94 "	"	" J. Heald	1				4	4	8
248	101 South Parade	"	" W. Ellingworth	1				1	1	2
249	103 "	"	" J. Wether	1				1	1	2
280	105 "	"	" A. Garsop	1				2	6	8
281	104 "	"	" B. W. Lister	1				2	1	3
282	109 "	"	" W. Laycock	1				1	3	4
283	111 "	"	" J. Hey	1				3	1	4
284	113 "	"	" R. Pickard	1				1	1	2
285	115 "	"	" W. H. Denton	1				1	3	4
286	1 Haggis Hill Rd.	"	" J. Marsden	1				1	2	3
287	3 "	"	" Mrs. M. Hewitt	1				2	2	4
288	5 "	"	" Mr. H. Dew	1				3	3	6
289	7 "	"	" J. D. Thompson	1				4	1	5
290	9 "	"	" J. Pickard	1				1	2	3
291	Seales Yd	"	" W. Goodridge	1				1	1	2
292	4 "	"	" W. Bennett	1				1	1	2
293	6 "	"	" B. Taylor	1				6		6
294	8 "	"	" W. Renshaw	1				1	1	2
Total to be carried forward to Abstract ...				25				64	52	119

Examples of the manner in which this Summary Book is to be filled up—continued.

Civil Parish.		Ecclesiastical Parish.		Borough or Urban District.						
<i>Manchester.</i>		<i>Ancoats St. Andrew.</i>		<i>Manchester.</i>						
Ward of Borough or Urban District.		Rural District.		Parliamentary Borough or Division.						
<i>St. Clement.</i>		<i>North West Manchester.</i>								
No. of Schedule.	Address.	Kind of Building. (For Blocks of Flats and Model Dwellings the Numbers of separate Flats or Tenements must be stated.)	Name of Occupier.	Dwellings or Tenements.			Population.			
				In-hab. htd.	Un-inhab. htd.	Build- ing not used as dwell- ings.	Males.	Fe- males.	Per- sons.	
1.	2.	3.	4.	5.	6.	7.	8.	9.	10.	11.
		Model Dwellings (1 Block, 30 Flats.)								
19	1 "		Mr. Robertson	1				2	2	4
20	2 "		" Andrews	1				2	3	5
	3 "					1				
21	4 "		Mr. Thomas	1				3	1	4
		Landseer Buildings (1 Block, 30 Flats, with 6 shops below.)					6			
22	1 "		" Barry	1				1	2	3
23	2 "		" Martin	1				1	3	4
		Wesleyan Chapel					1			
24	1 The Parade	Jam Factory	Mr. Johnson	1				1	1	2
	2 "	Lock-up Shop					1			
25	3 "	Shop	" Sanders	1				3	2	5
	4 "	"				1				
	5 "	Offices					1			
26	6-10 "	Drapery Establishment	Mr. Robinson	1				15	26	41
27	Albert Road, Queen's Hotel	Hotel	" Green	1				6	8	14
28	" " Queen's Hotel Stables	Stables	" Jenkins	1				1	1	2
29	" " "The Cedars"	Private House	Col. Packer	1				4	7	11
30	" " " " (Lodge)	Gardener's Lodge	Mr. Brown	1				1	2	3
31	" " St. Joseph's Home	Convalescent Home	Miss Howard	1				29	11	40
End of Ecclesiastical Parish of Ancoats St. Andrew.										
Total to be carried forward to Abstract ...				13	2		9	69	69	138

Example 6 Census Enumerator District Description 1891 See Slide 14

17

CENSUS OF ENGLAND AND WALES, 1891.

Registration District Northbury Enumeration District, No. 2
 Registration Sub-district Ossett Name of Enumerator, Mr. Walter Wilby

DESCRIPTION OF ENUMERATION DISTRICT.

[The description of the District is to be written in by the Enumerator in Column 9 from the Copy supplied to him by the Registrar. Any explanatory notes or observations calculated to make the description clearer, or more complete, may be added by the Enumerator. It is especially necessary that the names of the various Local Sub-Divisions should be inserted in Columns 1 to 8.]

Col. 1	2	3	4	5	6	7	8	9
Civil Parish	Municipal Borough	Municipal Ward	Urban Sanitary District	Town or Village, or Hamlet	Rural Sanitary District	Parliamentary Borough or Division	Eccelesiastical Parish or District	Description of Boundaries and Contents of Enumeration District.
<i>Ossett</i>	<i>Ossett</i>	<i>East "Part of"</i>	<i>Ossett</i>			<i>Morley.</i>	<i>Christ Church, (Part of)</i>	<p><i>Boundary, being that part bounded on the North by a footpath leading from bottom of Intake Lane to another footpath leading from Isaac Richards to Wakefield Road, on the North End by a portion of such last named footpath, on the East by South Parade to Spa Lane, part of Spa Road from the top of South Parade to Spa Lane, and by Spa Lane. On the South by the Township of Northbury, and on the West by Intake Lane, a footpath leading from Intake Lane to Park Square, Park Sq., Cowwood Lane, bottom of Northbury Lane, bottom of that part of Northbury Road in Township of Ossett.</i></p> <p><i>Contents, comprising Manor Road, Manor Lane, Park Sq. East of Cowwood Lane, Park Sq., and the footpath leading to the bottom of Intake Lane, West side of South Parade, West side of Spa Lane, East side of that part of Northbury Road in the Township of Ossett, Manor Mill.</i></p> <p><i>The whole in the Parliamentary Division of Morley.</i></p>

The Names of Local Sub-Divisions in Columns 1 to 8 should be written sideways.

Eng

PUBLIC RECORD OFFICE

Reference: **RG12 /3738**

COPYRIGHT - NOT TO BE REPRODUCED PHOTOGRAPHICALLY WITHOUT PERMISSION

Example 7 Inland Revenue Valuation Final Survey Record (page 1)

See Slide 15

1		2		THE NATIONAL ARCHIVES				1		2	
cms		Ref.:		IR 58 / 27168				Job No:		258173	
<small>Please note that this copy is supplied subject to The National Archives terms and conditions and that your use of it may be subject to copyright restrictions. Further information is given in the enclosed Terms and Conditions of supply of The National Archives leaflet.</small>											

185 Reference No. Map. No. 248.5.4.

Situation *South Savada*

Description *Houses Wood, Stable Land, Miscel*

Extent *5a. 0m. 18p.*

Gross Value	{ Land, £	Rateable Value	{ Land, £
	{ Buildings, £ 16.10.0		{ Buildings, £ 14.0.0

Gross Annual Value, Schedule A, £

Occupier *Leaac F. Kitchard*

Owner *Misses Sheila Popdington Hall, Kettering*

Interest of Owner *Freehold*

Superior interests

Subordinate interests

Occupier's tenancy, Term *yearly* from

How determinable

Actual (or Estimated) Rent, £ *20*

Any other Consideration paid

Outgoings—Land Tax, £ paid by

Tithe, £ paid by

Other Outgoings

Who pays (a) Rates and Taxes (b) Insurance *(a) occupier (b) owner*

Who is liable for repairs *same*

Fixed Charges, Easements, Common Rights and Restrictions

Former Sales. Dates

Interest

Consideration

Subsequent Expenditure

Owner's Estimate. Gross Value

Full Site Value

Total Value

Assessable Site Value

Site Value Deductions claimed *Yes.*

Roads and Sewers. Dates of Expenditure

Amounts

1 cms	2	THE NATIONAL ARCHIVES	1	2
Ref.: <u>IR 58 1 27168</u>		Job No: <u>258173</u>		
Please note that this copy is supplied subject to The National Archives terms and conditions and that your use of it may be subject to copyright restrictions. Further information is given in the enclosed 'Terms and Conditions of supply of The National Archives leaflet.				

Reference No.....185...

Particulars, description, and notes made on inspection
*Farm house of farm bldgs. Cottage & Land. Farm house contains
 Room, Kitchen, Store & Cellar. Cottage: House & Bed room.
 Farm bldgs. comprise 2 Stalls (used as garden
 Land behind house & first part of footpath) one grass
 field.*

*Stone built 4th floor repair
 185 & 78 valued together Amended in law.*

Charges, Easements, and Restrictions affecting market value of Fee Simple
*2 Footpaths £50
 Litch of 5 x 25' 4" P. 12. 117*

Valuation.— Market Value of Fee Simple in possession of whole property
 in its present condition

	Rent <u>£20 0 0</u>
Repairs Amur. & Litch	<u>2 10 0</u>
Ag. Value £1440 — £60 for cottage	<u>14 10 0</u>
	<u>25 10 0</u>

say £440

Deduct Market Value of Site under similar circumstances,
 but if divested of structures, timber, fruit trees, and
 other things growing on the land

£154

Difference Balance, being portion of market value attribut-
 able to structures, timber, &c. £286

Divided as follows:—

Buildings and Structures.....	£286
Machinery	£
Timber	£
Fruit Trees	£
Other things growing on land	£

Market Value of Fee Simple of Whole in its present condition
 (as before) £1440

Add for Additional Value represented by any of the following
 for which any deduction may have been made when
 arriving at Market Value:—

Charges (excluding Land Tax). Litch.....	£12 17
Restrictions.....	£50
	<u>£62 17</u>

GROSS VALUE... £1502 17

Example 8 Inland Revenue Valuation Annotated OS Map

See Slide 15



Example 9 Tithe Award Apportionment Schedule Entry See Slide 17

G.C.—London: Printed and Published (By Authority) by Shaw and Sons, Foster Lane.

LANDOWNERS.	OCCUPIERS.	Numbers referring to the Plan.	NAME AND DESCRIPTION OF LANDS AND PREMISES.	STATE OF CULTIVATION.	QUANTITIES IN STATUTE MEASURE.				REMARKS.			
					1	2	3	4				
Haigh Mary Hannah Elizabeth and Sarah continued	Robert Richard	414	Croft	Mea	1	20			R.17619.			
		420	Wheatley close	Mea	1	3		4				
		417	Wheatley close	Mea	1	3		9				
		340	Common Dykes	Mea	2	26		10 10				
					4	2	12		13 7			
	John Mitchell Senr.	750	Upper Gaddam	Pas	3	1		3	R.16024.			
890		Lower Gaddam	Mea	3	1		3					
					6	2		6				
George Ribah		411	Fieldside	Mea	2	1	25	2	5	R.17619. v		
		659	Burdleys	Pas	2	2	35		2	9		
		730	Sail small x x ?	Mea	1	3	18		1	10		
					6	3	36		7			
Thomas Mitchell		685	Eng	Pas	1	1	17		11	R.16024		
George Richard		193	Lower Park Wood	Mea	5	2	21		3	1	R.16024	
		191	Lower Park Wood	Mea	2	2	22		2	7	R.16024	
					5	3	3		5	2	R.17619.	
Joseph Burton		580	Croft	Mea	1	1	3		6	2	R.16024	
		380	Mappletwell	Mea & Pas	2	3	32		3	1		
					4	1			9	2		
Thomas Luarnside		734	Sail small high hill	Mea	1	3	20		1	11	R.16401.	
Joshua Ellis		664	Rippling	Mea	3	3	26		3	11	R.18715	
		665	Rippling	Mea	2	2	4		2	6		
					6	1	30		6	5		
Seth Ward		134	Washer Wood	Pas	2	1	10		2	4	R.16615.	
William Gunson		425	Bread Wood	Pas	5	2	10		5	7	R.17619.	
Healey Old Mill Co. Joshua Willy David Stephenson & others	Themselves	14	Land	Pas	1	30			5		R.18715	
		207	Lower Aries	Pas	4	3	14		4	10		
		209	Upper Aries	Pas	6	3	36		6	11		
		206	Cold Mills	Pas	1	2	30		1	9		
		206a	Cold Mills	Pas			13			1		
		10	East Healey	Mea	1	3	39		1	11		R.18715
202	East Healey	Pas	4	1	33		4	3				
			Lower Aries and		20	1	33		1	2		

43-310

Example 10 Tithe Award map 1843 See Slide 17

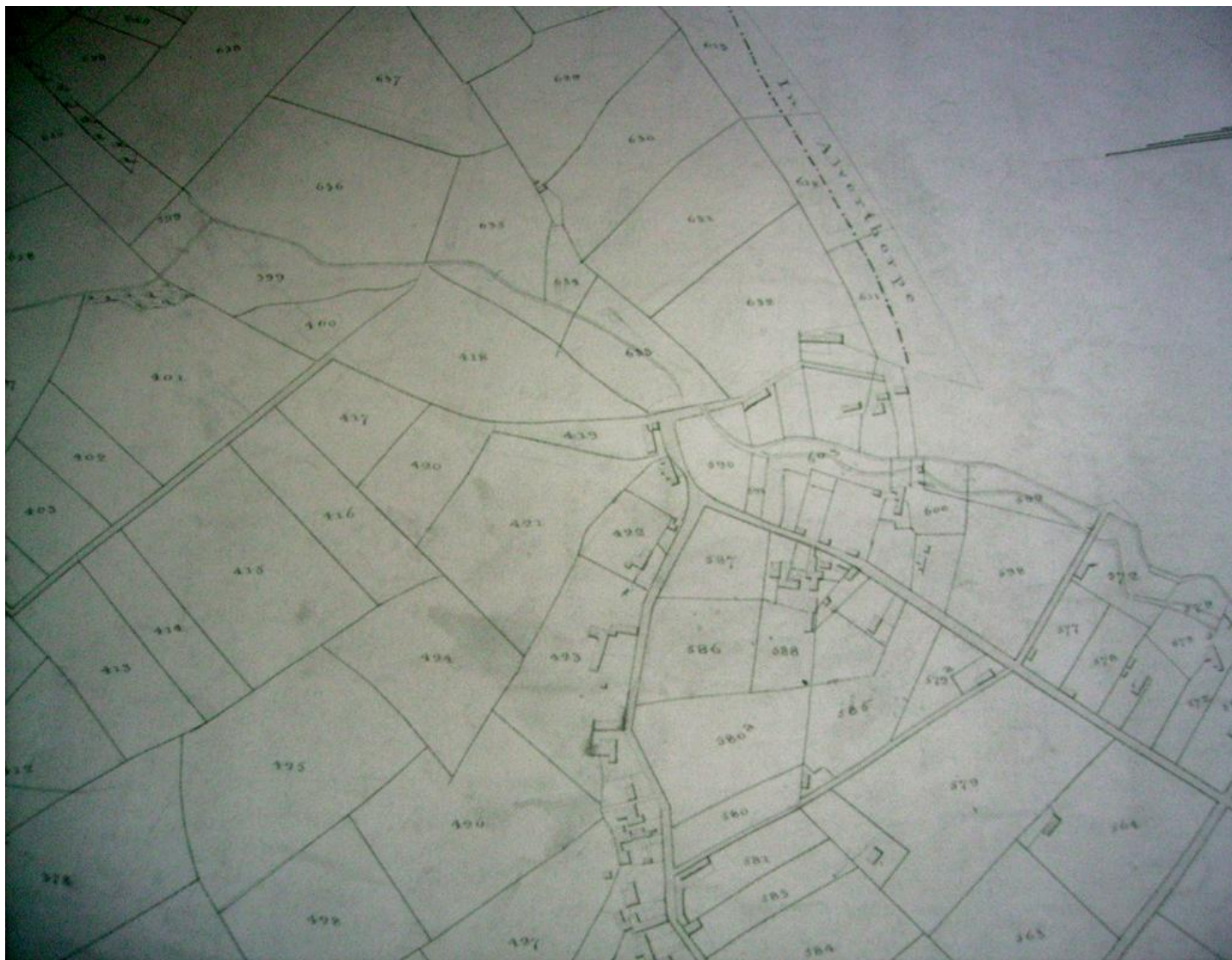

John Hanson.

0.. 1.. 12

ffencō

3 last allotments
ffencō.

Haigh.

Joshua Sen. Esq?

0.. 3.. 10

ffencō

0.. 0.. 07

ffencō

0.. 2.. 26

allotment situate on Osell Common containing one Acre and twelve perches, bounded Eastward by
 Kewell Road, Westward by another Allotment awarded to the said Benjamin Kallas and William
 Kallas, Northward by Herbury Road, and Southward by an Allotment awarded to Joshua Haigh
 the Elder. And I order and award that the said Benjamin Kallas the Younger and William
 Kallas shall make and forever hereafter maintain good and sufficient Fences on the Eastward and
 Westward Ends and Northward side of the said Allotment. And I declare that the said three last
 awarded Allotments are Freehold. Also I assign set out allot and award unto Joshua Haigh
 the Elder Esquire **All that allotment situate at Osell lower street side opposite certain pre-**
misses then called the long lands containing three Acres and ten perches, bounded Eastward by
the Wakefield and Halifax Turnpike Road, Westward by ancient premises now or late belonging to
the said Joshua Haigh, Northward terminating in a point, and bounded Southward by Rip-
pling Butts Road. And I order and award that the said Joshua Haigh shall make and for-
ever hereafter maintain good and sufficient fences on the eastward side and Southward End of
the said Allotment. And all that other allotment situate at Lights Bridge containing
seven perches, bounded Eastward and Northward by ancient premises now or late belonging to
the said Joshua Haigh, Westward by other ancient premises now or late belonging to John Lickins
and Southward by low common Road. And I order and award that the said Joshua Haigh shall
make and for ever hereafter maintain a good and sufficient Fence on the Southward side of the
said Allotment. And also all that other allotment situate at Lights Bridge containing

MS. A.108

LES

Example 12 Enclosure Order map (part) junction Hags Hill Road /Teal Town Road See Slide 18





51236
 8/136
 118
 136
 213

May 21st 1795.
 An Assessment for Messrs
 J. Craven & W. Illingworth
 Chapel Wardens for Ossett
 and Gawthorpe at the
 rate of ten the pound

Mr Raynor	18s
John Illingworth	34s
Mark Radley	12s
John Butterfield	12s
John Butterfield	12s
John Butterfield Jun	24s
Jos. Robinson	16s
Mark Pickard	9s
D. for Mr Halls	8s
David Pickard	29s
Geo. Pickard	4s
Jos. Brunnett	7s
D. for Fothergill	11s
	128 1/2

Handwritten signature or name, possibly 'John Illingworth'.

Handwritten signature or name, possibly 'David Pickard'.

Example 14 Land Tax Assessment Record 1798

See Slide 20

121

COUNTY of *York* *W. R.* Township *Ossett* PARISH of *Ossett & Gunthorpe*

Division of *Ossett*

An Assesment made in Pursuance of an Act of Parliament passed in the 38th Year of His Majesty's Reign, for granting an Aid to His Majesty by a Land Tax to be raised in Great Britain, for the Service of the Year *1798*.

1759

No. of Register.	Names of Proprietors.	Names of Occupiers.	Sums Assessed.			Date of Contract.
			£.	s.	d.	
	<i>Ossett.</i>					
<i>92347</i>	<i>Mess^{rs} Silas Thayer</i>	<i>Raynor</i>	<i>4</i>	<i>6</i>		
<i>74539</i>	<i>Mess^{rs} Pice Geo. S. Chambers</i>	<i>Son^r Shignorth</i>	<i>7</i>	<i>5</i>		<i>22 June 1799</i>
	<i>Mark Radley</i>	<i>Self</i>	<i>1</i>	<i>5</i>		
	<i>Jn^r Butterfield</i>	<i>Self</i>	<i>1</i>	<i>3</i>		
	<i>Jn^r "do</i>	<i>Self</i>	<i>1</i>	<i>3</i>		
	<i>do</i>	<i>Self</i>	<i>1</i>	<i>5</i>		
	<i>Jas. Robinson</i>	<i>Self</i>	<i>3</i>	<i>6</i>		
	<i>Jas. Haight</i>	<i>Mark Richard</i>	<i>1</i>	<i>10</i>		
	<i>do</i>	<i>Geo. Scott</i>	<i>1</i>	<i>10</i>		
	<i>Jn^r Bromitt</i>	<i>Self</i>	<i>1</i>	<i>5</i>		
<i>66566</i>	<i>Jn^r Willy</i>	<i>Mark Richard</i>	<i>1</i>	<i>7</i>		<i>1 June 1799</i>
	<i>do</i>	<i>Geo. Scott</i>	<i>6</i>	<i>1</i>		
	<i>Jn^r Dickenson</i>	<i>Geo. Richard</i>	<i>1</i>	<i>3</i>		
<i>41380</i>	<i>Barnabas Horst</i>	<i>Jn^r Bromitt</i>	<i>2</i>	<i>2</i>		<i>4 June 1799</i>

Example 16 Ossett Valuation Survey Entry 1775 Haigh-Lights Bridge See Slide 21

75

Haigh Haigh Lane

House Shop and Orchard.

Great Longlands.

Little Longlands.

House Longlands and by

Jack Lane

Middlelands

Upper Park Fields

Byat Field

Low Lane

Square Lane

Long Lane

Mowing Shop & Croft in hand fold

Mowing on the Green

Mowing on the Common

House & Light Bridge Pophill

House & Croft in System

House with two towers

Furnace and Croft

Long

Parsonage Pophill

Lower Parklands

Upper Park Pophill

Upper Croft

Valuation

ARR

10	1	22	3
5	1	24	113
5	1	15	113
2	1	15	126
6	25	14	14
4	1	15	106
2	26	11	279
3	33	9	143
3	30	12	159
2	28	12	153
			1106
			3
			14
			15
			110
			18
			116
		29	14
		317	15
		1	9
		5	225
		1	228
		2	318
			136
			156
			1596

09/06/2008

Example 17 Wakefield Manor Book entry 1709

See Slide 22

102 THE MANOR OF WAKEFIELD

[blank] Dewce Wid ^w for a Cottage in } Ossett }	0 0 2½
John Hirst for Carnel House }	0 0 6
Samuel Land & W ^m Nettleton in the } right of their wives for Lands in Ossett }	0 0 6
Joshua Ellis for a Cott[age] House & } Garth in Sowood Green }	0 0 1
Joshua Thompson for a Cott[age] House } in Sowood Green }	0 0 1
Robert Wright for a house & Land in } his own poss[ession] }	0 0 5
W ^m Bramley for a house & Garth on } Ossett Lights }	0 0 4
George Pickard for a house & Garth on } Ossett Lights }	0 0 2
Richard Fostard for Liversiege.. .. }	0 0 3
Joseph Naylor for a Cott[age] on Ossett } Lights late Wades }	0 0 4
John Townend for a house & Croft on } Ossett Lights }	0 0 6
Mary Ingham, Wid ^w for house & Land }	0 0 6
	0 10 0½
11 W ^m Ingham Jun for a Mess[uage] & } Lands late Grices }	0 2 11
Joshua Haigh for Lands late Grices }	0 2 0
W ^m Hirst & Richard Fostard for Lands } late Grices }	0 2 0
Josias Hepworth for Lands late Grices }	0 1 0
And have Help of Robert Nettleton for } Deyhouse }	0 0 1
John Ingham for his Lands }	0 0 3
John Scholefield for his Lands late John } Ingham }	0 0 3
W ^m Ingham Sen ^r for a Cott[age] late } Williams }	0 0 3
John Wade for a Cottage house }	0 0 4
W ^m Ingham Jun ^r for a Cott[age] } House & Peace Land.. .. }	0 0 7
John Jagger for a house in the poss- } [ession] of Rob: Jagger }	0 0 5
	0 10 1

Example 18 Hearth Tax Return (London manuscript entry 1666) See Slide 23

x James Langdale painter	1	Empty	3
Abraham Roberts	1	x John Bibis Turner	3
x Mary Merrifield	1	Thomas Farriner Baker	5
x Henry Brown Taylor	3	<small>1 oven</small>	1
x Edward Ratliffe bricklayer	7	William Ludford plasterer	3
Daniel Harris Cooper	5	<small>1 stove up</small>	1
Nathaniel Doggett Shingler	5	Joane	2
Empty	4	x Susanna Wood	3
x Thomas Dalton Car	5	Empty	3
Katherine Clarke miller	1	Lambe yard	
Pudding Lane, The East side		William Burgis hooker & ye mkr	3
x Richard Probs hooker & ye mkr	4	Joshua Sands platt worker	2
Mary Collier Cooper	7	Empty	3
Fish yard		x Christos Barker hooker & ye mkr	5
		Miss Grimrod	1

Example 19 Wakefield Manor Court Roll entry

See Slide 24

Admittance of
M^{rs} Eleanor Steele
 as Tenant for life
 under the Will of
Charles Wheatley
 Esq^{re} deceased.

37

Orig
 93
 No Roll

Manor and undistinguished ^{said} And all which said hereunto
 and premises comprised in the ^{said} First and Second parts of the said
 Schedule are delineated in the plan annexed to this Admittance
And whereas the said Charles Wheatley died on the
 Tenth day of December One thousand nine hundred having first
 made and executed his last Will and Testament in writing bearing
 date the Second day of March One thousand nine hundred (a Copy
 whereof is Inrolled in the Court Rolls of the said Manor and annexed
 to the Inrolment of this Admittance) whereof he thereby appointed
 Joshua Hirst Wheatley of Birkswell Hall near Coventry in the County
 of Warwick Esquire Joseph Wheatley of Woodlands in Hopton aforesaid
 Esquire The Reverend John Thornton Steele of Alverstone in the County
 of Hants Clerk in Holy Orders and John Shepley Standliffe of Over Hall
 in Miffield aforesaid Masters Executors and Trustees and after making
 certain pecuniary and Charitable bequests of personal estate as therein
 mentioned he devised all his real estate whatsoever and
wheresoever situate and of what nature or tenure soever To the use
of his relative Eleanor Steele (the Wife of Adam Rivers Steele
 of Loddington Hall Kettering in the County of Northampton Gentleman)
 and her assigns for the term of her natural life without impeachment
 of waste and for her sole and separate use and free from the debts or
 liabilities of her late husband and her future husband she might marry and

at Hagg's Hill, Orsett

333	Croft	Isaac Richard	-	1	20
333b	Mistal two Cottages Outbuildings yard and Garden	ditto	-	1	19

3